



IN CASE OF ALARM - FIRE

- Red motor fire symbol/red lamp **flashes** red.
- Alarm siren gives **repeating** acoustic signal.

Fire alarm signal - manufacturer's system:
See manufacturer's manual.

Fire alarm -

- Will sound until active alarm is turned off
- This should be done by authorised personnel.
- Fogmaker's alarm signal can be turned off by cutting off the supply of electricity.

Do not start the vehicle until the cause of the fire has been established and rectified!

Engine wash after fire -

- Clean up the engine compartment as soon as possible to prevent corrosion on metal parts and unwanted flash-overs in the electrical system.
- Hose down with water, preferably at high-pressure. Alkaline washing agents can be used.
- See also the manufacturer's recommendations for washing the engine compartment.

IN CASE OF ALARM - LOW PRESSURE

Low pressure signal with Fogmaker alarm:

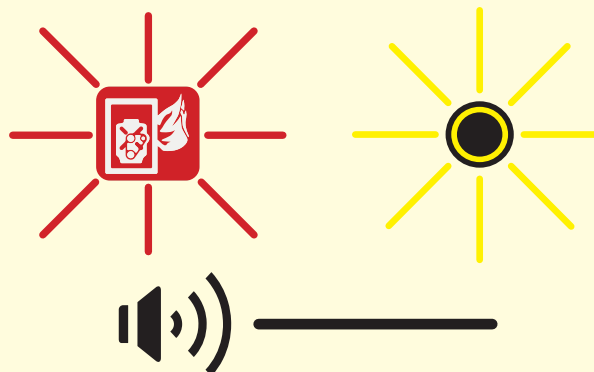

- Red engine fire symbol/yellow lamp **lights** constantly
- Alarm siren sounds **constantly**.

Low pressure signal - manufacturer's system:
See manufacturer's manual.



Contact service personnel

IN CASE OF ALARM - FIRE

Fire alarm signal - Fogmaker alarm:

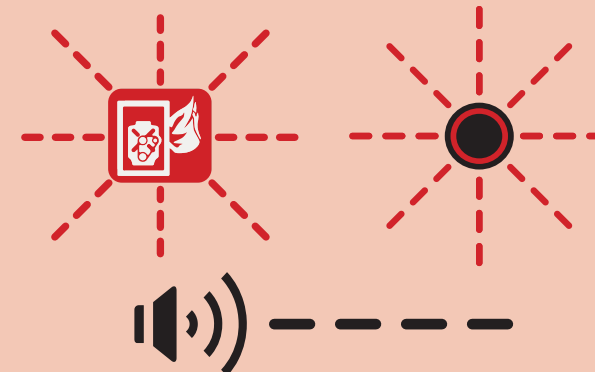

- Turn off engine**
- Evacuate vehicle**
- Turn off main power**
- Call emergency services**
- Keep engine hatch closed at least 5 minutes**
- If necessary, use a hand-held extinguisher**
- Contact service personnel**

8012-002 v. 3.2

Overview, Fogmaker's fire suppression system

This vehicle is fitted with a fully automatic fire suppression system for the engine compartment. The system may comprise of:

- piston accumulator (1)
- detector bottle (2)
- pipe system with nozzles (3)
- detector tube (4)
- Fogmaker alarm with acoustic and light signals or alternatively manufacturer-specific alarm panel (5)

NB! The system varies in different bus models.

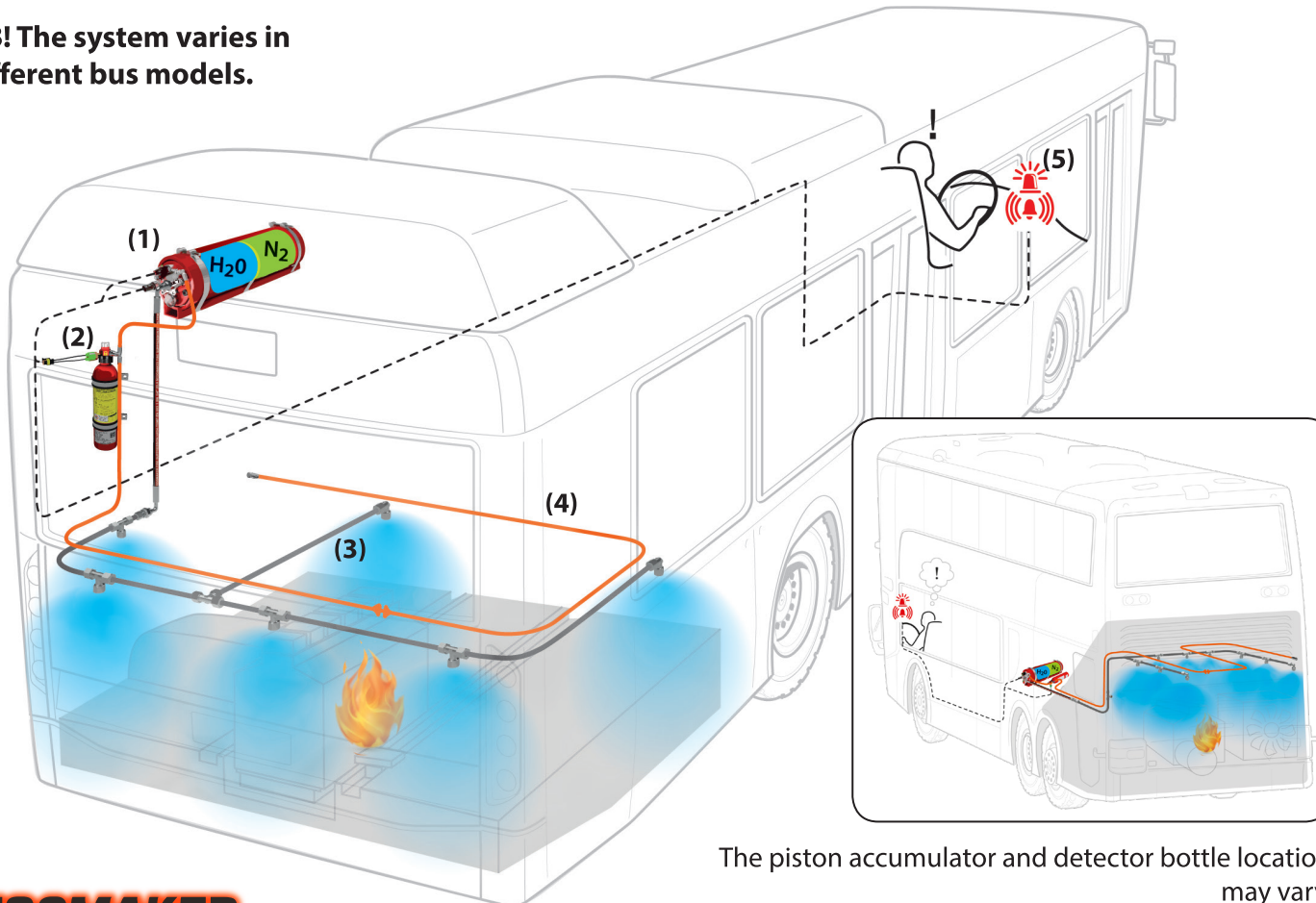

The piston accumulator and detector bottle location may vary.

ROUTINE MAINTENANCE

Pressure switch installed: Check that lamps indicating low pressure are not alight on the alarm button.

Pressure switch not installed: Make sure the pressure in the piston accumulator is within the green zone on the pressure gauge.

Test the alarm before starting the day's work.

Alarm test with the Fogmaker alarm:

- Press down the test button - two variants, see below:
- Check that there are both a sound and light signal.

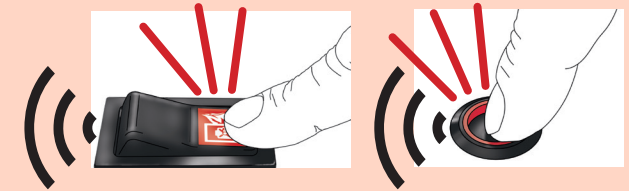

Alarm test - manufacturer's system:

See manufacturer's manual

Quick-guide for piston accumulator and detector bottle

Piston accumulator:
100-105 bar at 20°C

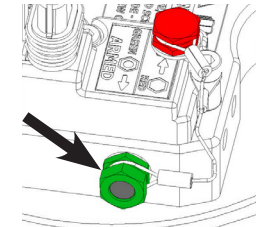

Green screw mounted in the side of the valve **and...**

Detector bottle:
20-24 bar at 20°C



...arrow pointed at **open padlock**, or...



...open ball valve...



→ ...arms the system - so that it may deploy in the event of a fire!

